



INFERNO FIRESTORM – ASSEMBLY INSTRUCTIONS & OWNERS MANUAL

Congratulations on your purchase of the Inferno Firestorm 200lb Compound Crossbow Package! Thank you for purchasing our product, we hope you have many years of enjoyment from our high quality crossbow package. This is a precision unit and should be treated with care and maintained properly for peak performance.

IMPORTANT – Please inspect your package contents carefully to ensure that the following items are included in the box.
(Phillips screwdriver required – NOT included)

- 1: Inferno Firestorm crossbow body (stock, trigger assembly, weaver style scope base, sling studs)
- 2: Inferno Firestorm 200lb riser assembly
- 3: Eye protection
- 4: Quick detach quiver
- 5: Quiver mounting hardware packet
- 6: Assembly Tools / hardware packet – allen wrenches, nose bolt, washer, cable slide
- 7: Rope cocking device
- 8: Rail lube
- 9: 4 – 20" Carbon fiber arrows with 100 grain practice points
10. 4x32 Illuminated multi reticle scope
- 11: Padded shoulder sling

STOP – IN THE UNLIKELY EVENT YOU ARE MISSING ANY OF THESE PARTS CALL ARROW PRECISION, LLC IMMEDIATELY (610) 437-7138 or Email sales@arrow-precision.com for immediate assistance.

FOR IMMEDIATE ASSISTANCE. DO NOT RETURN PRODUCT TO PLACE OF PURCHASE PLEASE CALL US DIRECTLY FOR SERVICE.



ASSEMBLY INSTRUCTIONS:

Step 1: Attach cable slide to cables as shown.

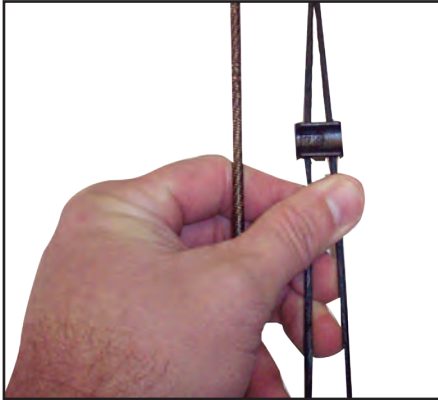

Step 2: Begin to assemble stock and riser assembly by positioning the bow string on the top of the rail and inserting the cable slide into position inside the rail to protect the cables from undue wear. **FAILURE TO USE THE CABLE SLIDE WILL RESULT IN CABLE DAMAGE** and will not be covered by the warranty. The profile of the cable slide is designed to match the profile of the aluminum rail of the crossbow and will protect the cables.



Step 2

Step 3: Position the riser assembly and the body/stock together and prepare the nose bolt and washer for installation. It is not necessary to try and force the stock and riser together, due to the precision machining and tight tolerance of the joint simply push the two pieces together so that they are properly aligned to be bolted together, and using the Allen key begin to tighten the nose bolt. The stock/body and riser will begin to cinch together as the nose bolt is tightened. Continue to tighten until the two pieces are securely tightened.



Step 3

Step 4: Flip the crossbow over and further secure the joint from potentially loosening by tightening the grub screw on the center of the underside of the riser as shown.

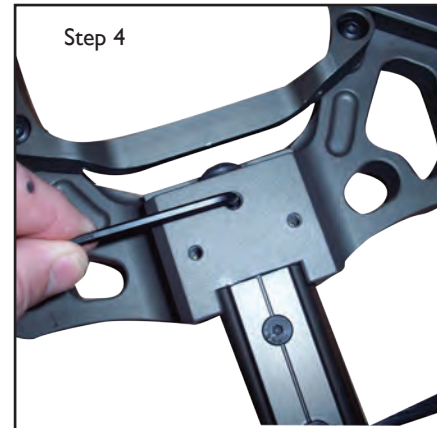

Step 4

Step 5: Attach quiver mount found in the quiver mount hardware packet to the underside of the riser using the 2 counter sink Allen screws provided in the quiver hardware packet as pictured.

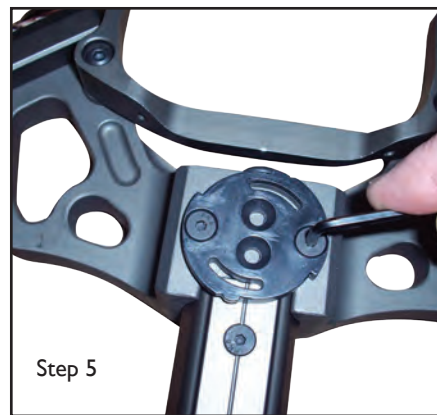

Step 5

Step 6: Attach the quiver bracket with latch onto the quiver using the 2 wood screws. You will need a Phillips screwdriver to accomplish this. The latch is shown in the open position ready to mount the assembled quiver onto the crossbow.



Step 6

Step 7: Attach the quick detach quiver to the quiver mounting bracket using a twisting motion. The quiver should be at a diagonal angle in order to properly seat on the quick detach bracket prior to twisting into the fixed position.

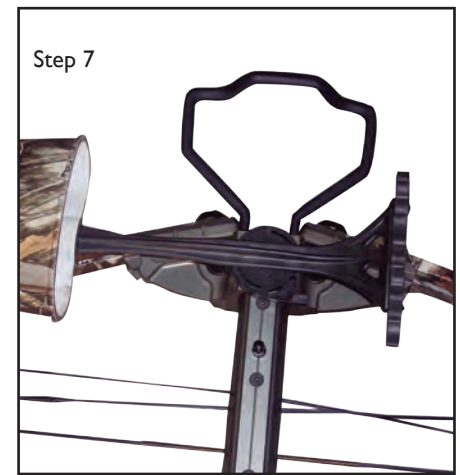

Step 7

Step 8: Attach the padded shoulder sling to the crossbow. Loosen the thumb screw on the sling swivel so that the swivel may be attached to the sling studs located on the underside of the crossbow stock. Tighten the thumb screws securely on both swivels.

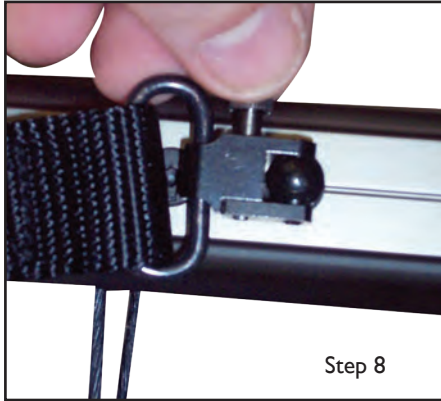

Step 9: Prepare to Mount 4x32 Scope. In order for your Firestorm to shoot with utmost precision and accuracy your scope must be mounted true and level. Inspect the weaver style scope base for level. Visually check to ensure that scope base is flat and level. It should be level from the factory, however if the mount is loose or appears to be out of level you will need to adjust the leveler screws located inside 2 access holes on top of the scope mount. Please note the outer two holes contain the leveler screws, you will not be utilizing the other hole.



With the aid of a small level adjust the scope base until it is level and true. Begin by loosening the 2 leveler screws until the mount is able to be rocked slightly up and down with the pivot point being the center of the mount. Tighten or loosen the rear leveler screw until your base is level, then tighten the front leveler screw until the base is secure and tight. Tighten both levelers securely and you are now ready to mount your scope.



Step 10: Loosen the clamps on the scope mount and align the crossbar on the clamps with the slots on the weaver style base and tighten down as shown.



STOP – BEFORE YOU ATTEMPT TO SHOOT YOUR FIRESTORM CROSSBOW READ THIS

Your Firestorm Crossbow is equipped with an anti dry-fire mechanism, this may be different than other crossbows you have owned and you must be familiar with the basic operation of the trigger prior to use. Please familiarize yourself with these steps:

- 1: **YOU MUST BE SURE**, prior to attempting to cock the Firestorm crossbow that the safety switch is in the **“FIRE”** position.
- 2: The crossbow **WILL NOT** cock if the safety switch is moved to the **“SAFE”** position.
- 3: Once you have cocked the crossbow, the safety will automatically be engaged and the safety switch will now be in the **“SAFE”** position.
- 4: You **WILL NOT** be able to release the safety until you are ready to shoot the crossbow and you have placed an arrow on the rail and have the arrow positioned and ready to fire the bow.
- 5: This is to prevent an accidental dry-fire (shooting without an arrow) of the crossbow.
- 6: Once you place the arrow into position, you may release the safety to the **“FIRE”** position
- 7: Shoot at your target - Once the bow is shot the safety will remain in the **“FIRE”** position until you cock the bow again and repeat the process.

FINAL ADJUSTMENTS TO YOUR CROSSBOW

MARK YOUR STRING:

In order to achieve the highest level of accuracy it is recommended that you take the time to mark your string to ensure that you are cocking the bow in a consistent manner. Due to the high draw weight involved in cocking the bow it is easy to cock the crossbow off center. Failure to cock the crossbow squarely and with consistency will result in poor accuracy. Simply mark the string with a permanent marker or other means to visibly ensure the bow is being cocked properly.



IMPORTANT: LUBRICATE THE STRING SERVING AND RAIL AT THIS TIME. FAILURE TO DO SO WILL RESULT IN EXCESS FRICTION, THE STRING SERVING BURNING AND WEARING OUT PREMATURELY

COCKING THE CROSSBOW

The best way to cock the Inferno Firestorm crossbow is through the use of the included rope cocking device. To use the rope cocking device, simply grasp the of the hooks and drape the rope over the groove located behind the trigger mechanism/scope mount and continue to

place the hooks onto the crossbow string on each side of the flight track. Once this is accomplished simply grasp the molded handles through the straps, hold crossbow to a level surface using the foot stirrup and pull the string back until it latches in the trigger. Using this method, the draw weight will be reduced by 50% and the string will cock in a consistent manner each time.



To manually cock the crossbow follow the instructions below.

Place the foot stirrup on the ground in a flat and stable area. Insert your foot into the stirrup and securely hold the crossbow down to the ground with the weight of your body. With one hand on each side of the flight track, securely grasp the string as close as possible to the flight track. Begin drawing the string back towards the trigger mechanism, being sure to keep the string in contact with the flight track. Continue pulling the string back into position, being sure to keep the alignment straight. The trigger latch and safety will automatically engage when you have reached the back of the trigger housing.

Once cocked, the marks should be visible in the same position on each side of the trigger mechanism. You are now ready to load the crossbow with an arrow.

Warning do not dry fire (fire without an arrow) your crossbow. Your crossbow is equipped with an anti-dryfire trigger. You will not be able to release the safety until an arrow is inserted into shooting position. Therefore we strongly urge you to only unload your crossbow by shooting it at a safe target. Attempting to uncock the string by hand is dangerous and may cause damage to the crossbow, and/or physical harm, as well as void your warranty. Do not attempt this.

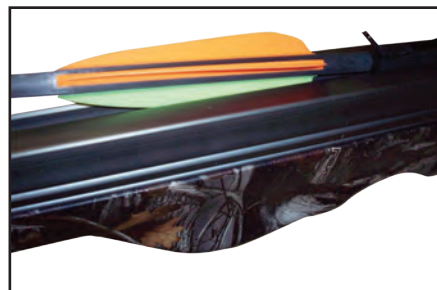

When loading an arrow into your crossbow, be sure to check that the arrow is in good condition is free from defects and is straight and true. It should lay in the flight track without any bends or other issues that would cause erratic flight of the arrow. Insert the arrow onto the flight track with the index fletch (odd colored fletch) down in the groove of the flight track as pictured.

It is **IMPERATIVE** that the arrow is seated ALL the way back with the half moon nock cradled against the string. If this is not done the string may jump the arrow or may go under the arrow

– which would be equivalent to dry firing the bow (Firing without an arrow – this would void your warranty and damage could occur)



FIRING THE CROSSBOW

With the arrow correctly loaded and an appropriate target is in position with adequate backstop provided release the automatic safety and pull the trigger to fire the crossbow. We recommend you start sighting in your bow at a maximum distance of 10 yards in order to be sure that your aim is on target. Once the unit is sighted in at close range, further distances may be attainable.

RECOMMENDED ARROWS

The Firestorm crossbow includes 4 – 20" carbon fiber arrows equipped with 100 grain practice points. These arrows are appropriate for target shooting and hunting provided the tips are changed out and replaced with proper hunting tips of the same grain weight. If expendable broadheads are legal in your area then we recommend they be utilized. You may alter your arrow setup using 20" aluminum arrows with 100 grain practice points available through your Inferno dealer. Minimum arrow and tip weight of 350 grains is required.

Thank you for your purchase. We wish you great success in your hunting and target shooting pursuits!



Basic Sighting of Your Scope

Your Firestorm crossbow includes a 4x32 multi-reticle crossbow scope, we suggest beginning to sight in your crossbow at no more than 10 yards to ensure that you are able to hit the target easily to avoid loss or damage of your arrows. You will be sighting in the TOP LINE on your scope for the shortest distance. Using an appropriate target designed for crossbows, begin by first checking to see if you will hit the target with your shot, similar to bore sighting aim at the target and verify that you will hit the intended target. It is a good idea to use some sort of rest to ensure that you are aiming consistently. Take your first shot aiming at the center bullseye, and examine where on the target the arrow has hit.

Depending on where the shot hit you will need to adjust the windage knob (Left and right) and elevation (up and down) knob on the scope in the direction indicated on the scope adjustment knobs to make the correction. Continue repeating the process until you are zeroed in at 10 yards and then begin to move slowly further away from the target to your desired first yardage making adjustments to windage and elevation as necessary. The other lines below the top line will offer you additional yardage sight points, the lower the line the further the distance. These distances will depend on your initial yardage sighting of the top line, and also depend on your arrow configuration (arrow shaft length, size and weight of tip).

#106



Optional Accessories:

- #185 Firestorm String \$29.99
- #106 20" Carbon Arrows 6 Pack \$39.99
- #180 Crossbow Case \$49.99
- #122 Crank Cocking Device \$129.99
- #129 Rail Lube 3 Pack \$7.99
- #103 Upgraded Illuminated 4x32 Scope \$99.99
- #121 3-Dot Red Dot \$49.99

#180



#185



#129



#121



#122



#103



Arrow Precision, LLC
1619 W Washington Street
Allentown, PA 18102
sales@arrow-precision.com

Tel: 610 437 7138
Fax: 610 437 7139
www.arrow-precision.com

Arrow Precision, LLC Inferno Crossbows and Youth Archery Set One Year Limited Warranty

Manufacturer warrants to be free from defects in material and workmanship under normal use and service for 1 year from date of purchase. It does not cover damage resulting from abuse or misuse, repairs or alterations performed by other than the manufacturer or authorized service center, or damage occurring in transit. Not covered are strings, cables, and other items which require periodic replacement. Damage resulting from dry firing (firing unit without an arrow), whether intentional or accidental; including instances where arrow is not seated properly resulting in damage to the limbs, cables, wheels, string, etc.

For warranty service, unit should be well packed to avoid damage in transit, including a description of the difficulty, and shipped postage prepaid to Arrow Precision, LLC at the address below. Arrow Precision, LLC will repair or replace at no charge and return postage prepaid. For customers living outside the United States, Arrow Precision, LLC will provide standard warranty service. However, inbound & outbound shipping cost is the responsibility of the consumer. If failure was caused by misuse, alterations, accident, or abnormal conditions of operation, an estimate for repairs will be submitted for your approval prior to work being performed.

Include a copy of the original sales receipt, along with the form below and mail to Arrow Precision, LLC in order to register your product and activate your warranty.

If you have questions concerning this product or warranty, contact Arrow Precision, LLC, asking for warranty assistance.

**Arrow Precision, LLC
1619 W Washington Street
Allentown, PA 18102
Telephone (610) 437-7138
Fax (610) 437-7139
Email: Sales@arrow-precision.com
www.arrow-precision.com**

Model Name _____ Date Purchased _____
Last Name _____ First Name _____
Street Address _____
City _____ State _____ Zip Code _____
Email: _____
Dealer Name _____ City _____ State _____
Price Paid _____ Intended Use _____
(hunting, target, other)